

HEC MILLING CHUCK (AM TYPE)

HEC 精銑夾頭刀柄 (AM型)

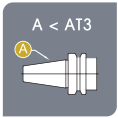

Taper tolerance
錐度公差

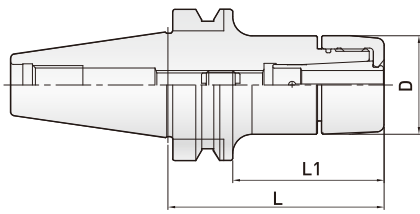
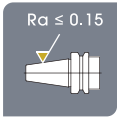

Surface roughness
表面粗度

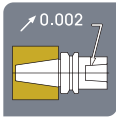

Run out accuracy
內孔偏擺度



Surface hardness
表面硬度

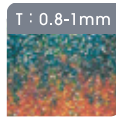

Carbonized depth
滲碳深度

Order Code 訂購編號	L	L1	D	Min ¹ G2.5 動態平衡	Nut 螺帽	Spanner 扳手	Collet 筒夾
BT30-HEC8-75AM	75	53	30	30,000	CN-HEC8AM	30194-830	HEC8
HEC12-75AM	75	53	42	30,000	CN-HEC12AM	30194-842	HEC12
BT40-HEC8-90AM	90	63	30	30,000	CN-HEC8AM	30194-830	HEC8
HEC12-90AM	90	63	42	30,000	CN-HEC12AM	30194-842	HEC12

- Clamping nut design by circular cylinder. Bearing spanner must be used.
- End mill chuck specially designed for hard cutting material.
- Superior surface finish for mold tools and 3-D work.
- Bearing spanner and stop screw must be ordered separately.
- 全圓螺帽，必須使用軸承扳手。
- 專門為難切削材設計的銑刀夾頭。
- 在模具加工時，表面光滑度極佳。
- 軸承扳手及止動螺絲必須另外訂購。



HEC COLLET

HEC 筒夾

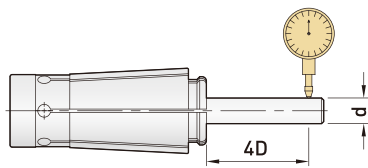

- Runout <math>< 5\mu\text{m}</math> [4×D]
- 跳動精度 <math>< 5\mu\text{m}</math> [4×D]

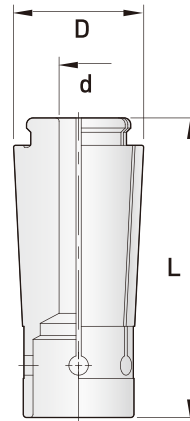

Order Code 訂購編號	d	(d) 持夾徑	L	D
HEC8-3	3	3	35	16
4	4	4		
5	5	5		
6	6	6		
8	8	8		
HEC12-4	4	4	46	20
6	6	6		
8	8	8		
10	10	10		
12	12	12		

HEC NUT (AC TYPE)

HEC 螺帽 (AC型)



Order Code 訂購編號	Outside Dia 外徑	Collet 筒夾規格
CN-HEC8AC	30	HEC8
HEC12AC	42	HEC12

HEC NUT (AM TYPE)

HEC 螺帽 (AM型)



Order Code 訂購編號	Outside Dia 外徑	Collet 筒夾規格
CN-HEC8AM	30	HEC8
HEC12AM	42	HEC12

SPANNER

扳手



Order Code 訂購編號	Type 型式
30194-724	SP-HEC8
702	SP-HEC12



Order Code 訂購編號	Nut 螺帽規格	inside Dia 內徑
30194-830	CN-HEC8AM	30
842	CN-HEC12AM	42